

WHAT'S IN THE BOX

Make sure the following items are in your box:

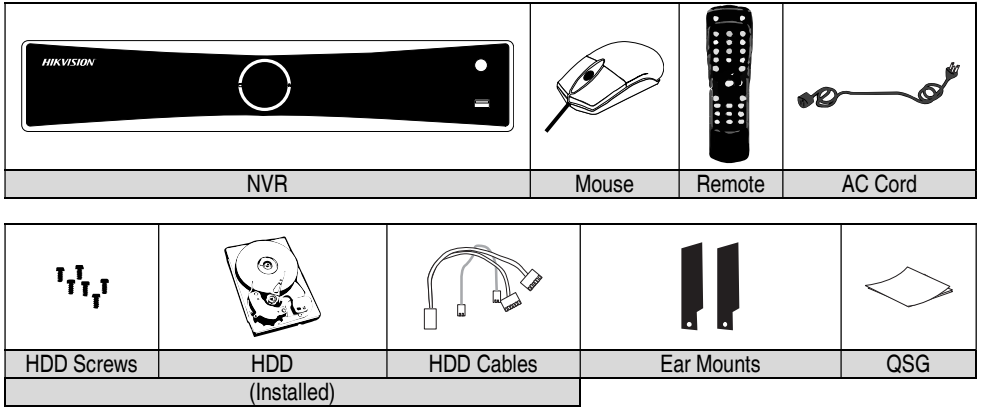

MENU TREE

Use this menu tree to navigate the embedded menus.

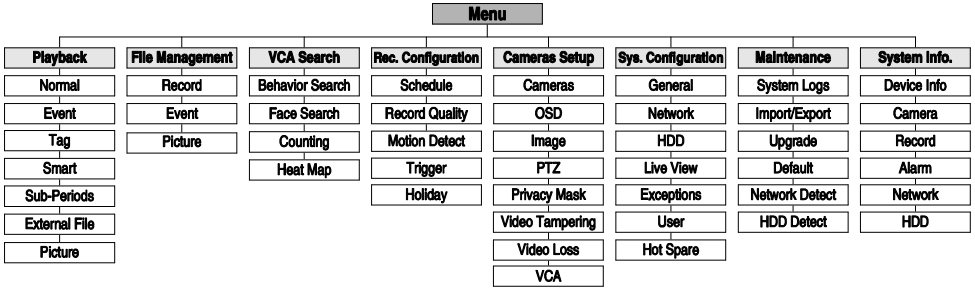

FRONT PANEL

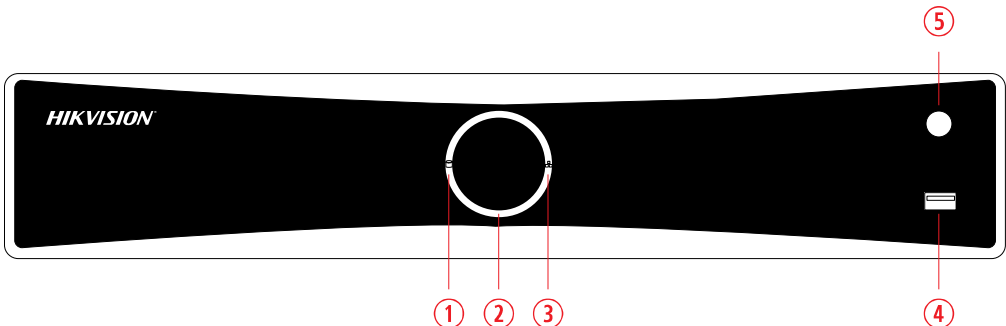

Figure 1, DS-76xxNXI-I2/xxP/4S Front Panel

FRONT PANEL (continued)

No.	Item	Description
①	HDD Indicator LED	<ul style="list-style-type: none"> • Solid white: HDD is abnormal • Flashing white: HDD is reading/writing • Unlit: No HDD is detected
②	Power LED Ring	<ul style="list-style-type: none"> • Solid White: Device is running normally • Breathing Light: Device is shut down • Unlit: No power supply is connected
③	Network Indicator LED	<ul style="list-style-type: none"> • Solid White: Network connection is normal • Flashing White: Device is transferring data via network • Unlit: Network connection failed
④	USB Port	Universal Serial Bus (USB) 2.0 port for additional devices such as USB mouse and USB Hard Disk Drive (HDD)
⑤	IR Sensor	IR receiver for remote control

REAR PANEL

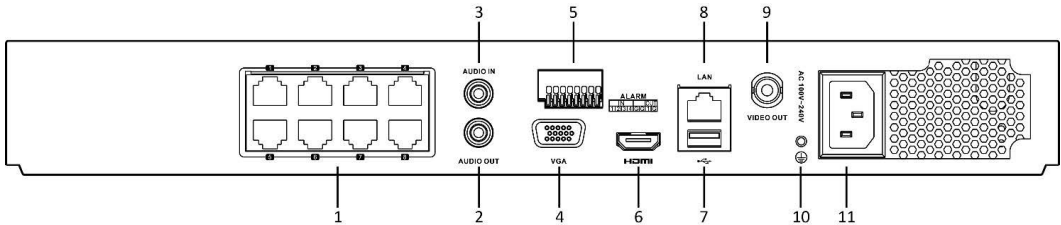

Figure 2, DS-7608NXI-I2/8P/4S Rear Panel

No.	Item	Description
①	PoE Interfaces	IP camera inputs and PoE outputs (8 for DS-7608NXI-I2/8P/4S, and 16 for DS-7616NXI-I2/16P/4S)
②	Audio output	RCA connector
③	Audio input	RCA connector
④	VGA output	DB-15 connector for VGA output (display local video output and menu)
⑤	Controller port, alarm I/O	Alarm input and output connectors
⑥	HDMI output	1 x HDMI video output connector
⑦	USB 3.0 interface	USB 3.0 port for additional devices
⑧	LAN network interface	Connector for LAN (Local Area Network)
⑨	Video output	CVBS output
⑩	GND	Ground (WARNING: needs to be connected before NVR starts up)
⑪	Power input	100 to 240 VAC

1

CONNECT DEVICES

1. Connect AC power cord to the NVR.
2. Connect NVR to LAN using Cat 5e cable.
3. Connect video monitor(s) to NVR using HDMI and/or VGA cables, as appropriate.
4. Connect mouse to USB port (wireless mouse can be used in lieu of included mouse).
5. Connect to audio I/O using RCA connectors.

2

START THE NVR

1. Plug AC power cord into grounded 110 to 240 VAC outlet (surge suppressor is recommended).
2. Turn power switch on. Power indicator LED ring will glow white to indicate unit is starting.
3. After startup, power indicator LED ring will remain glowing white.

3

LOCAL ACTIVATION

System access requires a secure, user-assigned password.

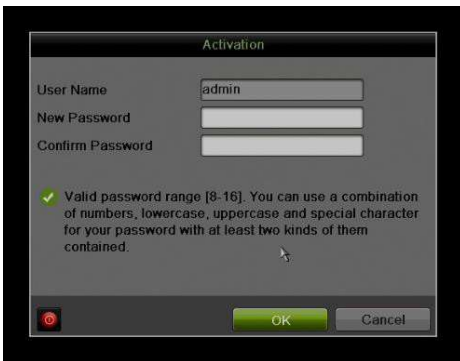

▼ Set Admin Password

First-time access requires user to create an admin password.

1. Input same password in **Create New Password** and **Confirm New Password** text fields.



Strong Password REQUIRED

Password must contain 8 to 16 characters, combining numbers, lower and upper case letters, and special characters. At least two types of the above-mentioned characters are required. Also, reset password regularly.

2. Click **OK** to save password and activate device.

▼ Set Unlock Pattern

Admin user will be prompted to configure an unlock pattern for login in place of a password.

1. Hold down left mouse button and draw a pattern by connecting at least four dots on the screen, with each dot connected only once). Release mouse button when done.
2. Draw the same pattern again to confirm it.

NOTE: If you forget your pattern, select Switch User to display the normal login dialog box.

▼ Log In (Unlock Pattern)

1. Draw the unlock pattern to unlock system.

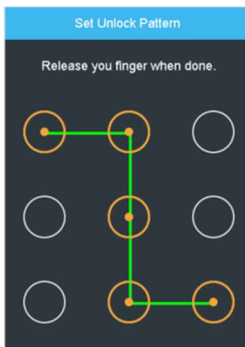

3 LOCAL ACTIVATION (continued)



▼ Log In (Dialog Box)

1. **User Name** field will be prefilled with "admin."
2. Input **Password** (account locks for 30 minutes after 7 incorrect attempts).
3. Click **OK**.

4 INITIALIZE THE HARD DRIVE (IF NEEDED)

The system is set up to record upon power up and will beep and display "Do you want to initialize drive" prompt if the hard drives are not initialized.

1. Go to MENU > SYSTEM CONFIGURATION > HDD.
2. Check the checkboxes of HDDs that need to be initialized.
3. Press **INIT**. (Factory installed HDDs come initialized. Initializing again will erase any record video. This does not affect settings).

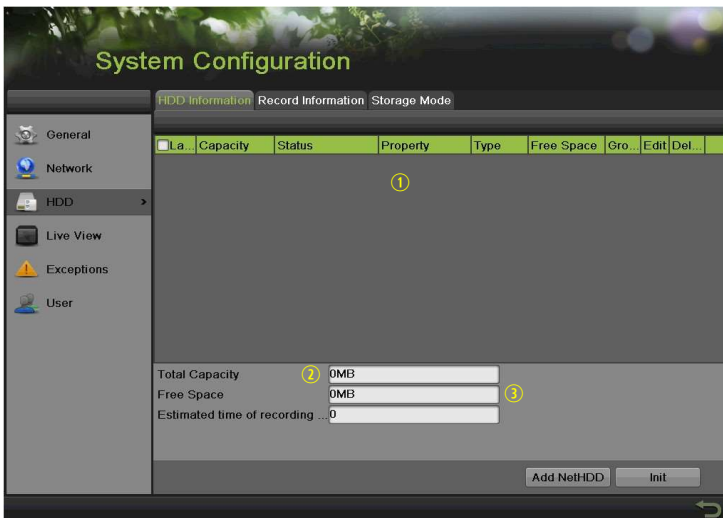

- ① HDD LIST
- ② TOTAL HDD SPACE
- ③ FREE SPACE

5

CHECK HARD DRIVE HEALTH (Seagate HDDs Only)

View the HDD health status (Seagate 4 TB to 8 TB HDD built after 10/1/17 only) to help troubleshoot HDD problems. HDD Health Detection shows HDD status with more details than the S.M.A.R.T. function.

1. Go to MAINTENANCE > HDD OPERATION > HEALTH DETECTION.
2. Click an HDD to view details.



① HDD Operation > Health Detection

② Total number of HDDs

③ Click to show HDD details

6

SET DATE AND TIME

1. Go to MENU > SYSTEM CONFIGURATION > GENERAL.



① DATE/TIME
Date and time settings

② TIME ZONE
Time zone and daylight savings time settings

③ ENABLE NTP
Network Time Protocol settings

7

SET UP NETWORK ACCESS

1. A network connection is required to access the cameras remotely.
2. Go to MENU > SYSTEM CONFIGURATION > NETWORK.
3. Enable DHCP (check the checkbox).
4. Press **Refresh** button to update the IPv4 address, subnet mask, and IPv4 default gateway.
5. Disable DHCP (uncheck the checkbox).
6. Change "Preferred DNS Server" value to 8.8.8.8 (leave Alternate DNS Server blank).

7 SET UP NETWORK ACCESS (continued)

The screenshot shows the 'System Configuration' interface with the 'Network' tab selected. The 'General' sub-tab is active. The following fields are highlighted with numbered callouts:

- 1: General tab
- 2: NIC Type dropdown menu
- 3: Enable DHCP checkbox
- 4: Refresh button
- 5: IPv4 Address field
- 6: Preferred DNS Server field
- 7: Alternate DNS Server field

NIC Type	10M/100M/1000M Se		
Enable DHCP	<input type="checkbox"/>		
IPv4 Address	192.168.0.30	IPv6 Address 1	2605:6001:e483:c700:c
IPv4 Subnet Mask	255.255.255.0	IPv6 Address 2	fe80::c62f:90ff:fe8f:9c9d
IPv4 Default Gateway	192.168.0.1	IPv6 Default Gateway	fe80::eafc:afff:fe81:abat
MTU(Bytes)	1500	MAC Address	c4:2f:90:8f:9c:9a
DNS Server			
Preferred DNS Server	8.8.8.8		
Alternate DNS Server			
Internal NIC IPv4 Addr...	192.168.254.1		

- 1 GENERAL TAB**
Select this tab
- 2 NIC TYPE**
Set LAN type
- 3 ENABLE DHCP**
Check box so that router will assign IP address
- 4 REFRESH**
Press to update values
- 5 IP V4 ADDRESS**
Default 192.0.0.64
- 6 PREFERRED DNS SERVER**
Default is 8.8.8.8
- 7 ALTERNATE DNS SERVER**
Leave blank

8 SET CAMERA PORTS

After assigning the IP information, click the **More Settings** tab.

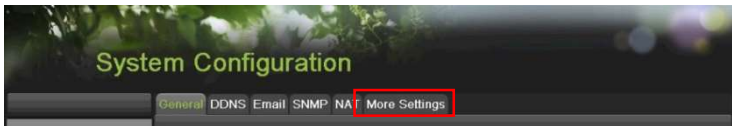

The **More Settings** tab contains the ports that need to be forwarded for remote access.

The screenshot shows the 'System Configuration' interface with the 'More Settings' tab selected. The following fields are visible:

Alarm Host	
Alarm Host IP	
Alarm Host Port	0
Port	
Server Port	8000
HTTP Port	80
Multicast IP	
RTSP Port	10554
More	
Enable High-speed Download	<input checked="" type="checkbox"/>
Enable Telnet	<input checked="" type="checkbox"/>

- **SERVER PORT** is responsible for the mobile app and client software log-in.
- **HTTP PORT** is responsible for Web browser log-in.
- **RTSP PORT** is responsible for video/audio streaming.

NOTE: The **HTTP port**, **server port**, and **RTSP** can be changed to avoid conflicts with the ISP or if multiple devices are installed at a single location.

9

SET UP HIK-CONNECT P2P CLOUD SERVICE

1. Enable Hik-Connect P2P on the device.
 - 1) Go to MENU > CONFIGURATION > NETWORK > PLATFORM ACCESS.

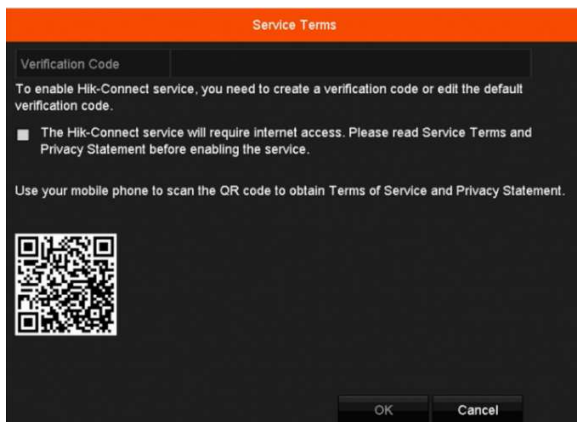

- 2) If the Server Address field is blank, check **Custom** checkbox and type “dev.us.hik-connect.com.”
- 3) Check the **Enable** checkbox to display the Service Terms screen.
- 4) Enter a user-created verification code (6-12 characters, a combination of digits, upper case letters, and lower case letters).
- 5) Check the “The Hik-Connect Service will require Internet access. Please read...” checkbox.
- 6) Click **OK**. Status will change to “Online” (if all settings are correct).
- 7) Note the Serial Number and Verification Code shown (for use when registering the NVR in your Hik-Connect account) or use the QR code displayed.

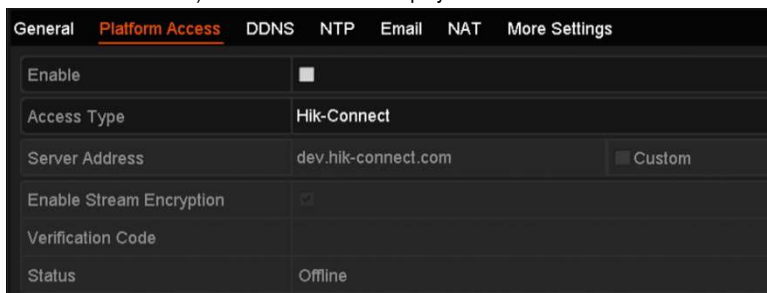







2. To see a device's video stream on the Hik-Connect or iVMS-4500 mobile app, add the device.
 - 1) Login to Hik-Connect mobile app with your user name, e-mail, or mobile number and password.
 - 2) Click “+” (upper right corner) on the Home screen.
 - 3) Enter the device's information.
 - If you have device's **QR Code**: Use the QR Code Scanner to scan the device's **QR Code**.
 - If you do not have device's **QR Code**: Enter the device information manually:
 - a. Click **Edit** (pencil) on top right corner.
 - b. Enter device serial number (device must be online), then click **OK**.
 - c. When the device appears on the “Results” screen, click **Add**.
 - d. Enter device's 6-character Verification Code (all upper case), then click **OK**.
3. Click **Finish**.

10

ADD IP CAMERAS

1. Right click a window in **Live View** mode to display the menu.
 2. Click **Menu** to display Menu choices.
 3. Click **Cameras Setup** to display the Add Cameras window.
 4. Add camera(s) as follows:
 - **Hikvision Camera Connected to Unit's PoE Port** — Will automatically be added to an NVR camera channel (Dx) and will be visible on the camera list in white within two minutes.
 - **Hikvision Camera Connected to the Network but Not Unit's PoE Ports** — Will automatically be detected and displayed at bottom of camera list in yellow. Must add to camera channel manually:
 - 1) Click an unused camera channel's **Dx** checkbox.
 - 2) Click the **EDIT** (Pencil) button to display the **Edit IP Camera** window.
 - 3) Use pull-down menu to change **Adding Method** from "Plug and Play" to "Manual."
 - 4) Enter the camera's IP address and other information as required.
 - 5) Press the **OK** button to add the camera.
 - **Hikvision Cameras Not Detected** — Must be added manually:
 - 1) Click an unused camera channel's **Dx** checkbox.
 - 2) Click the **EDIT** (Pencil) button to display the **Edit IP Camera** window.
 - 3) Use pull-down menu to change **Adding Method** from "Plug and Play" to "Manual."
 - 4) Enter the camera's IP address and other information as required.
 - 5) Press the **OK** button to add the camera.
- NOTE:** If camera does not connect, use SADP program to find/modify camera settings.
- **Third-Party Cameras** – Must be added manually:
 - 1) Click an unused camera channel's **Dx** checkbox.
 - 2) Click the **EDIT** (Pencil) button to display the **Edit IP Camera** window.
 - 3) Use pull-down menu to change **Adding Method** from "Plug and Play" to "Manual."
 - 4) Enter the camera's IP address and other information as required.
 - 5) Press the **OK** button to add the camera.

IP Camera Management Icons

Icon	Explanation	Icon	Explanation
	Edit basic camera parameters		Upgrade the connected camera
	Camera disconnected; click for camera's exception information		Delete the IP camera
	Play camera's live video		Camera connected

10 ADD IP CAMERAS (continued)



- 1 **NVR CAMERA CHANNELS**
Cameras connected to NVR
- 2 **PLAY**
Play camera's live video
- 3 **EDIT (Pencil)**
Change IP address (in LAN range)
- 4 **CAMERA LIST (White)**
Added cameras
- 5 **LAN CAMERAS LIST (Yellow)**
Detected cameras will appear here
- 6 **CAMERA CONNECTED**
Shows camera is connected
- 7 **CAMERA DISCONNECTED**
Shows disconnected camera
- 8 **PASSWORD VISIBLE**
Show passwords
- 9 **ENABLE H.265**
Use H.265

11 VIEW LIVE VIDEO

Live View displays real-time video.



Icons in the upper right of screen show each camera's record and alarm status.

- **Alarm** (video loss, tampering, motion detection, sensor alarm, or VCA alarm)
- **Record** (manual record, continuous record, motion detection, alarm, or VCA triggered record)
- **Event/Exception** (event and exception information appears at lower-left corner of screen)

12 SET UP RECORDING

The system defaults to continuously record video at 8 fps, or at 15 fps when motion is detected.

▼ Recording Schedule

Default is to continuously record everyday. Do the following to change the recording schedule:

1. Go to MENU > RECORDING CONFIGURATION > SCHEDULE.
2. Choose **CONTINUOUS** or **EVENT/(MOTION DETECTION)** under the **Type** pull-down menu.
3. Use cursor to select (days will turn blue [continuous] or yellow [event/motion detect]) or deselect (days will turn gray [off]) the calendar days you wish to record.

12 SET UP RECORDING (continued)

4. Apply time settings as desired.
5. Press **APPLY**.



- 1 **TYPE**
Motion or Continuous (default)
- 2 **COLOR**
Shows Recording Schedule days:
 - Blue=Continuous
 - Yellow=Event (motion/alarm)
 - Grey=None
- 3 **TIMES**
Customize schedule times (ignore for "motion only" recording)
- 4 **ADD**
Press to add time settings to schedule
- 5 **ENABLE SCHEDULE**
If not checked, camera will not record

▼ Motion Detection Areas

To define the image areas that Motion Detection will monitor for each camera, do the following:

1. Go to MENU > RECORDING CONFIGURATION > MOTION DETECT.
2. Use **Camera** pull-down menu to select camera to configure.
3. Check the **Enable Motion Detection** checkbox to enable motion detection.
4. Use the **Sensitivity** boxes to select how responsive the detection should be (the more green boxes lit, the greater the sensitivity).
5. Drag a grid(s) over the area(s) on the image that will be sensitive to motion.
6. Click the **Settings Set** button to configure **Arming Schedule** (when detection is enabled) and **Linkage Actions** (what action(s) to take when motion is detected).

12 SET UP RECORDING (continued)



- 1 **CAMERA**
Select camera
- 2 **ENABLE MOTION DETECTION**
Click to enable/disable
- 3 **MOTION GRID**
Draw grid area that will detect motion
- 4 **SENSITIVITY**
Select number of green squares to set sensitivity (in example, sensitivity is set to 3)
- 5 **SETTINGS/SET**
Configure arming schedule and linkage actions
- 6 **APPLY**
Click to apply settings

▼ Record Quality

• Main Stream

1. Go to **RECORDING CONFIGURATION > RECORD QUALITY > MAIN STREAM** and set the following items:
 - **Stream Type** enables/disables audio streaming from the cameras (if the camera does not have audio capabilities, **Stream Type** will have only **Video** option).
 - **Resolution** sets recording resolution.
 - **Bitrate Type** saves HDD space when set to **Variable**. Choices: **Variable** and **Constant**.

IP Cameras

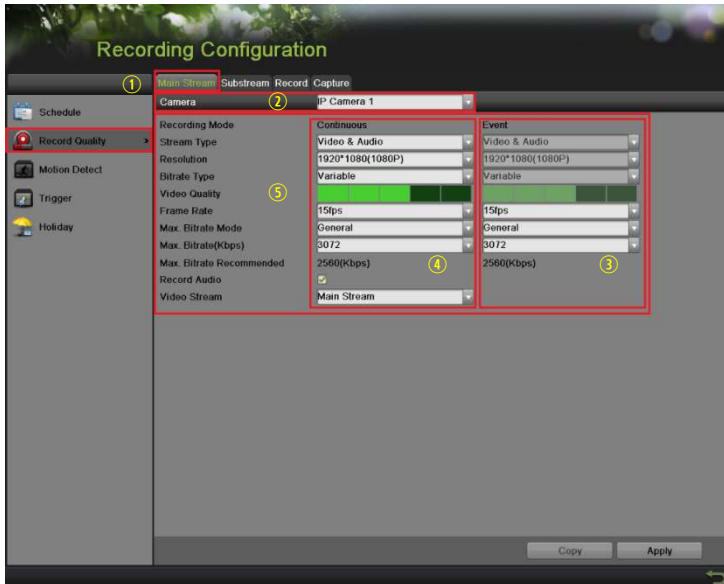

- 1 **MAIN STREAM**
Select tab
- 2 **CAMERA**
Select IP camera
- 3 **EVENT**
For event recording only (motion or alarm)
- 4 **CONTINUOUS**
For live view image and continuous recording
- 5 **VIDEO QUALITY**
Select number of green squares to set quality (in example, sensitivity is set to 3)

12 SET UP RECORDING (continued)

- **Video Quality** adjusts picture clarity (high setting = four green squares is default). Consider highest if hard drive space allows. Medium setting is a balance between good picture and saving HDD space.
 - **Frame Rate** sets recording frame rate (8 fps on continuous and 15 on motion by default). Higher frame rates require more storage, but allows better slow motion playback.
 - **Max Bitrate Mode** chooses between pre-set bitrate values and customized values (**General** setting is default).
 - **Max Bitrate (kbps)** is the chosen bitrate for streaming the video. Max Bitrate should be adjusted to meet or exceed the rate recommended by the system for the chosen parameters.
 - **Max Bitrate Recommended** is impacted by resolution, quality, and framerate.
 - **Record Audio** turns on audio recording. Requires connection of external microphone or camera with built in mic.
 - **Video Stream** determines which stream is recorded. Leave at default (Main Stream).
- **Substream**
 1. Go to RECORDING CONFIGURATION > RECORD QUALITY > SUBSTREAM to set up the **Sub Stream** to stream to mobile devices and display multiple cameras locally.

NOTE: If the upload speed is not sufficient, lower the frame rate, bitrate, and or resolution for more fluent mobile viewing.

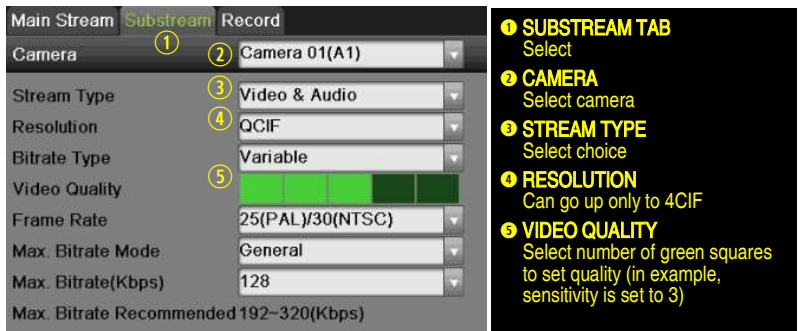

1 SUBSTREAM TAB
Select

2 CAMERA
Select camera

3 STREAM TYPE
Select choice

4 RESOLUTION
Can go up only to 4CIF

5 VIDEO QUALITY
Select number of green squares to set quality (in example, sensitivity is set to 3)

13 PLAY BACK RECORDED VIDEO

1. Go to MENU > PLAYBACK.
2. Select the desired camera(s) from the menu on the right of the screen.
3. Select the desired date (days that contain recordings will be blue if recording was continuous only or yellow if all or part of the day was event recording).
4. Press **PLAY**.
5. Click within the timeline to jump to desired time.

13 PLAY BACK RECORDED VIDEO (continued)



- ❶ **PLAYBACK TYPE MENU**
Select type of record to play
- ❷ **FULL SCREEN**
Goes to full screen for multiple channel playback
- ❸ **PLAY/STOP**
Begin playback (toggles between Play and Stop)
- ❹ **CAMERA LIST**
Select camera(s) to play back
- ❺ **CALENDAR**
Select date to play back
- ❻ **TIMELINE**
Click on timeline to jump to desired playback time

Playback Controls

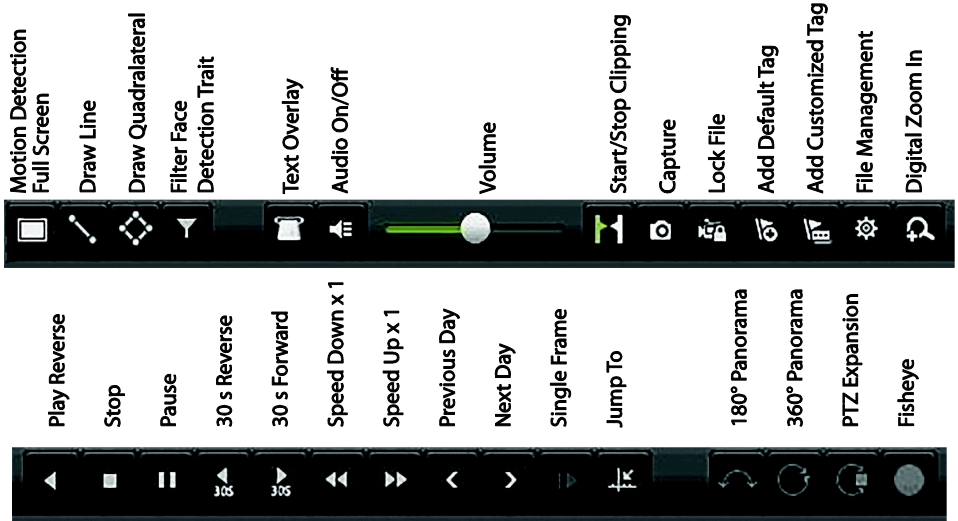

▼ Play Back Record Files

1. Go to MENU > LIVE VIEW.
2. Left click a Live View window to bring up a shortcut toolbar and click on the  icon for instant playback.

▼ Playback Controls



1. Right click a Live Image to display a Quick menu and click on  icon for instant playback.

14

BACK UP VIDEO RECORDINGS AND CLIPS

Back up recorded video clips to ensure important video is not lost or destroyed.

▼ Choose Recorded Video Clips To Back Up

1. Connect a USB flash drive, HDD, or DVD writer to an available USB port (this step is mandatory).
2. Go to MENU > PLAYBACK.
3. Select cameras for playback.
4. Select the date and beginning time of the incident.
5. Click **START CLIPPING**  button.
6. Select the ending time of the incident.
7. Click **END CLIPPING**  button (same button as **START CLIPPING**). Clip will be marked.
8. Repeat steps 1-6 as many times as required.
9. Click **FILE MANAGEMENT**  button to display a new window containing all marked clips.
10. Select the desired clips.
11. Click **EXPORT** to save files to the inserted USB device.



1 CAMERA LIST

Select cameras to view

2 CALENDAR

Select dates to view

3 PLAY/STOP

Toggles between Play and Stop

4 START/STOP CLIPPING

Toggles between Start Clipping and Stop Clipping

5 LOCK

Locks selected video clips to prevent them from being deleted

6 FILE MANAGEMENT

Displays list of saved clips, export clips from this window

▼ Lock Video Clips

1. Click on the images of the clips you want to lock.
2. Press the **LOCK**  button to prevent the file from being erased.

▼ Back Up Video Clips

3. Connect a USB flash drive, HDD, or DVD writer to an available USB port.
4. Click on the File Management button to display the File Management window.
5. In the File Management window, choose video clip(s) to back up and click **Export** button.

14 BACK UP VIDEO RECORDINGS AND CLIPS (continued)

6. Choose backup device (USB flash drive, USB HDD, or DVD writer).
7. Click **Export** (to check backup, choose recorded file in **Export** interface and click  button).



- 1 VIDEO CLIPS LIST
Select desired clips to export
- 2 EXPORT BUTTON
Save clips to USB device



First Choice for Security Professionals

Hikvision USA Inc., 18639 Railroad Street, City of Industry, CA 91748, USA

Hikvision Canada, 4848 rue Levy, St-Laurent, Quebec, Canada, H4R 2P1

Telephone: +1-909-895-0400 • Toll Free in USA: +1-866-200-6690

E-Mail: sales.usa@hikvision.com • www.hikvision.com

© 2016–2019 Hikvision USA Inc. • All Rights Reserved

Specifications subject to change without notice.

QSG DS-77xxNXI-H4/16P/4S 080219NA
