

DS-KD-ACFx/Plastic

Flush Mount Package Series

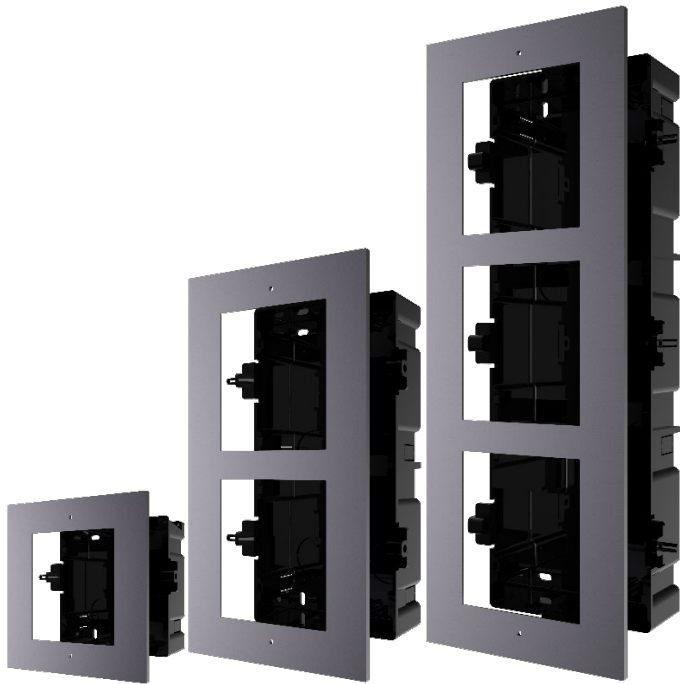

DS-KD-ACF1

DS-KD-ACF2

DS-KD-ACF3

The DS-KD-ACFx/Plastic Package Series is designed to support modular door station modules. Generally, customers choose to pair this accessory with a Video Intercom Module Door Station.

The DS-KD-ACFx/Plastic Series has a high-quality aluminum cover plate and contains all of the necessary hardware elements for integration with other Hikvision products for custom access control solutions.

Available Models:

DS-KD-ACF1/Plastic: Holds one module

DS-KD-ACF2/Plastic: Holds two modules

DS-KD-ACF3/Plastic: Holds three modules

- Contains Gang Box, Cover Plate, Screws, Module Cable(s), etc.
- Adapts to Door Station Modules
- Aviation-Grade Aluminum Cover Plate

Specifications

	DS-KD-ACF1/Plastic	DS-KD-ACF2/Plastic	DS-KD-ACF3/Plastic
Cover Plate Material	Aviation aluminum		
Gang Box Material	Plastic		
Working Temperature	-40° to 131° F (-40° to 55° C)		
Working Humidity	10% to 95% (non-condensing)		
Cover Plate Dimensions (L x W x D)	134 mm × 124 mm × 4 mm (5.28" × 4.88" × 0.16")	236 mm × 124 mm × 4 mm (9.29" × 4.88" × 0.16")	337.8 mm × 124 mm × 4 mm (13.3" × 4.88" × 0.16")
Gang Box Dimensions (L x W x D)	134 mm × 135 mm × 56 mm (5.28" × 5.31" × 2.20")	237 mm × 135 mm × 56 mm (9.33" × 5.31" × 2.20")	338.8 mm × 135 mm × 56 mm (13.33" × 5.31" × 2.20")
Weight	366 g (with packaging) 195 g (without packaging)	588 g (with packaging) 290 g (without packaging)	784 g (with packaging) 420 g (without packaging)

Dimensions

DS-KD-ACF1/Plastic

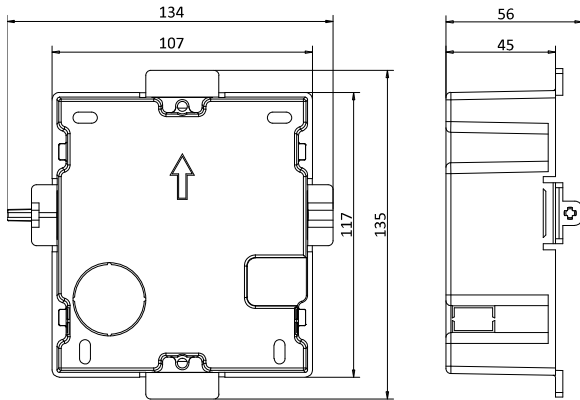

DS-KD-ACF2/Plastic

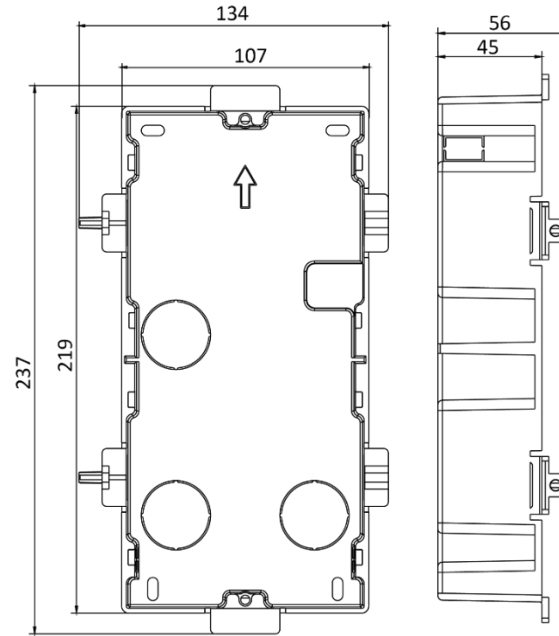

DS-KD-ACF3/Plastic

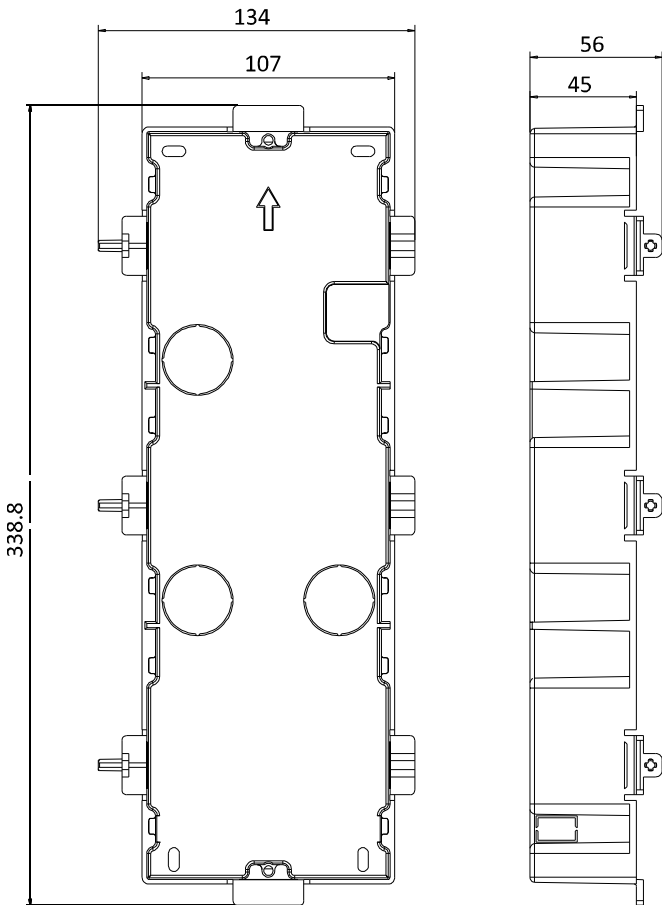

Unit:mm