

DS-2CD2D21G0(/M)-D/NF

2 MP Indoor Mini Network Camera



Pinhole Model



Covert Model

- 1/2.7" Progressive Scan CMOS
- Up to 1920 x 1080 Resolution @ 30 fps
- H.265+, H.265, H.264+, H.264
- 120 dB True WDR
- 3D DNR
- 6 Behavior Analyses, 2 Exception Detections
- 12 VDC, Maximum 3 W

The Hikvision DS-2CD2D21G0(/M)-D/NF Indoor Mini Network Camera provides high definition output. It supports H.265+ video compression, which assures savings in bandwidth and storage.

Pinhole and covert models are available, which facilitate surveillance in sensitive situations that require discretion.

Smart features such as line crossing, intrusion, unattended luggage, and scene change detection are also supported.

Available models:

DS-2CD2D21G0-D/NF: Pinhole
DS-2CD2D21G0/M-D/NF: Covert

Box Contents (Subject to Change)

Quick Start Guide x 2
Screws
Bracket x 2



Specifications

DS-2CD2D2160-D/NF		DS-2CD2D2160/M-D/NF	
Camera			
Image Sensor	1/2.7" progressive scan CMOS		
Minimum Illumination	Color: 0.025 lux @ [f/1.2, AGC on], 0.109 lux @ [f/2.5, AGC on] B/W: 0.005 lux @ [f/1.2, AGC on], 0.022 lux @ [f/2.5, AGC on]	Color: 0.025 lux @ [f/1.2, AGC on], 0.069 lux @ [f/2.0, AGC on] B/W: 0.005 lux @ [f/1.2, AGC on], 0.014 lux @ [f/2.0, AGC on]	
Shutter Speed	1/3 s to 1/100,000 s		
Slow Shutter	Yes		
Auto-Iris	No		
Day/Night	Electronic		
Digital Noise Reduction	3D DNR		
WDR	120 dB		
Lens			
Focal Length	3.7 mm	2.8 mm or 4 mm	
Focus	Fixed		
FOV	3.7 mm: Horizontal FOV: 78°, vertical FOV: 43°, diagonal FOV: 90°	2.8 mm: Horizontal FOV: 114°, vertical FOV: 62°, diagonal FOV: 135° 4 mm: Horizontal FOV: 86°, vertical FOV: 46°, diagonal FOV: 102.5°	
Lens Mount	M12		
Compression Standard			
Video Compression	H.265/H.264+/H.264		
H.264 Type	Baseline profile/main profile/high profile		
H.264+	Yes		
H.265 Type	Main profile		
H.265+	Yes		
Video Bit Rate	32 Kbps to 8 Mbps		
Smart Features			
Behavior Analysis	Line crossing detection, intrusion detection, region entrance detection, region exit detection, unattended baggage detection, object removal detection		
Exception Detection	Scene change detection, defocus detection		
Face Detection	Yes		
Region of Interest	Supports one fixed region for main stream and sub-stream		
Image			
Maximum Resolution	1920 × 1080		
Main Stream	30 fps [1920 × 1080, 1280 × 960, 1280 × 720]		
Sub Stream	30 fps [704 × 480, 640 × 480, 352 × 240]		
Third Stream	1 fps [1920 × 1080, 1280 × 960, 1280 × 720, 704 × 480, 640 × 480]		
Image Enhancement	3D DNR		
Image Setting	Rotate mode, saturation, brightness, contrast, sharpness adjustable by client software or Web browser		
Day/Night Switch	Day/night/auto/schedule		
Network			
Network Storage	Supports NAS (NFS, SMB/CIFS)		
Alarm Trigger	Motion detection, video tampering, IP address conflict, illegal login		
Protocols	TCP/IP, ICMP, HTTP, HTTPS, FTP, DHCP, DNS, DDNS, RTP, RTSP, RTCP, PPPoE, NTP, UPnP, SMTP, SNMP, IGMP, 802.1x, QoS, IPv6, Bonjour		
General Function	One-key reset, anti-flicker, three streams, heartbeat, password protection, privacy mask, watermark, IP address filter		
API	ONVIF (PROFILE S, PROFILE G), ISAPI		
Simultaneous Live View	Up to 6 channels		
User/Host	Up to 32 users; three levels: administrator, operator, and user		
Client	iVMS-4200, iVMS-4500, Hik-Connect		
Web Browser	IE 8+, Chrome 31.0–44, Firefox 30.0–51, Safari 8.0+		
Interface			
Audio	1 input (line in)		
Communication Interface	1-port RJ-45 10M/100M self-adaptive Ethernet port		
Reset Button	Yes		
General			
Operating Conditions	-22° to 140° F [-30° to 60° C], humidity 95% or less [non-condensing]		
Power Supply	12 VDC ±25%, Ø5.5 mm coaxial plug power		
Power Consumption and Current	12 VDC, 0.3 A, maximum 3 W		
Material	Aluminum alloy		
Dimensions	1.2" x 1.2" x 1.5" [31 mm x 31 mm x 39 mm]	1.2" x 1.2" x 1" [31 mm x 31 mm x 26 mm]	
Weight	0.2 lbs [0.93 kg]		

Dimensions

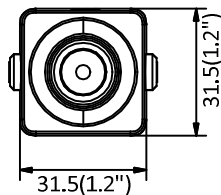

Pinhole Model

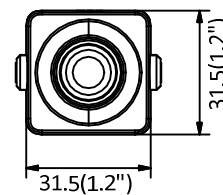
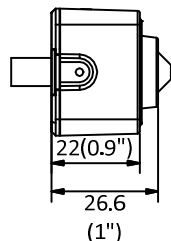

Covert Model

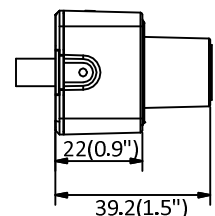

Units: mm (inch)