

Title:	RN Two-Wire IP Intercom v1.4.45 v2.0.0 021020NA	Version:	v1.4.45, v2.0.0	Date:	021020
Product:	DS-KH8340-TCE2 and DS-KV8103-IME2	Build:	190410	Page:	1 of 5
Action Required:	None, Information Only				

■ General Information

Firmware for the following products have been updated to add new features:

Device Model	Firmware Versions and Builds
DS-KH8340-TCE2	v1.4.45_190410
DS-KV8103-IME2	v2.0.0_190410

NOTE: To complete the upgrade, manually restore default settings after new firmware installation.

■ v1.4.45/v2.0.0_190410 (Current Version)

• New Features

- One main door station and one door station extension supported
- Default time zone set to GMT-8

■ v1.4.45/v2.0.0_181126 (Previous Version)

• Bug Fixes

- DHCP bug was fixed by changing the synchronization mechanism between indoor and outdoor stations.
 - > When DHCP was enabled on the door station, the IP address could only be changed once.
 - > When DHCP was disabled on the indoor station, the IP could be changed more than once.

■ v1.4.45/V2.0.0_180824 (Previous Version)

• Modified Functions

- Eight languages supported: English, Italian, German, French, Spanish, Polish, Dutch, and Czech
- One indoor station and three indoor extensions supported. Indoor extensions (room number extensions range: 1-3) can call each other by dialing the room number. A total of five indoor and outdoor stations supported, with a maximum of two outdoor stations.
- Plug-and-play supported (simple configuration can be completed on indoor touch screen without using external PC software). Once the indoor station is turned on, the user will be asked to follow these steps: **Activation → Select Language → Select Indoor Station Type** (main indoor station or indoor extension).
 - > For Indoor Station: **Add Door Station → Active Door Station → Synchronize to Door Station.**

Title:	RN Two-Wire IP Intercom v1.4.45 v2.0.0 021020NA	Version:	v1.4.45, v2.0.0	Date:	021020
Product:	DS-KH8340-TCE2 and DS-KV8103-IME2	Build:	190410	Page:	2 of 5
Action Required:	None, Information Only				

> For Indoor Extension: **Add Main Indoor Station.**

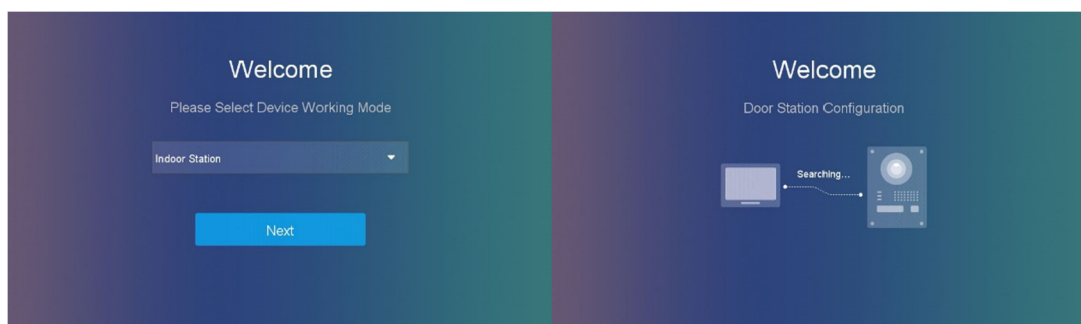
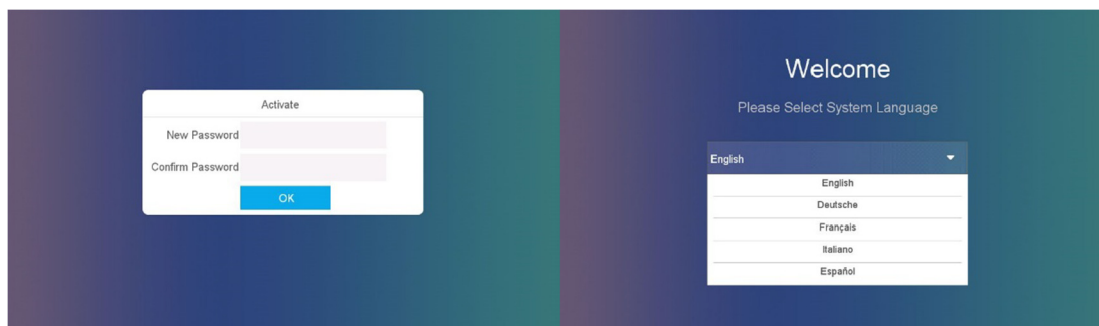

Main Indoor Station

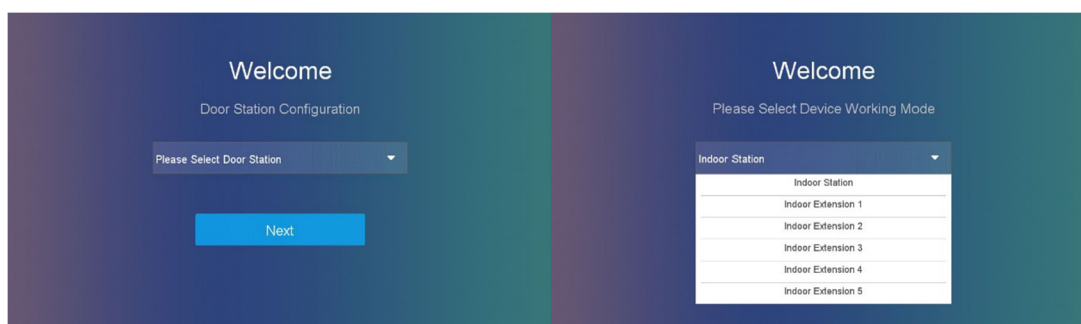

Indoor Extension

Title:	RN Two-Wire IP Intercom v1.4.45 v2.0.0 021020NA	Version:	v1.4.45, v2.0.0	Date:	021020
Product:	DS-KH8340-TCE2 and DS-KV8103-IME2	Build:	190410	Page:	3 of 5
Action Required:	None, Information Only				

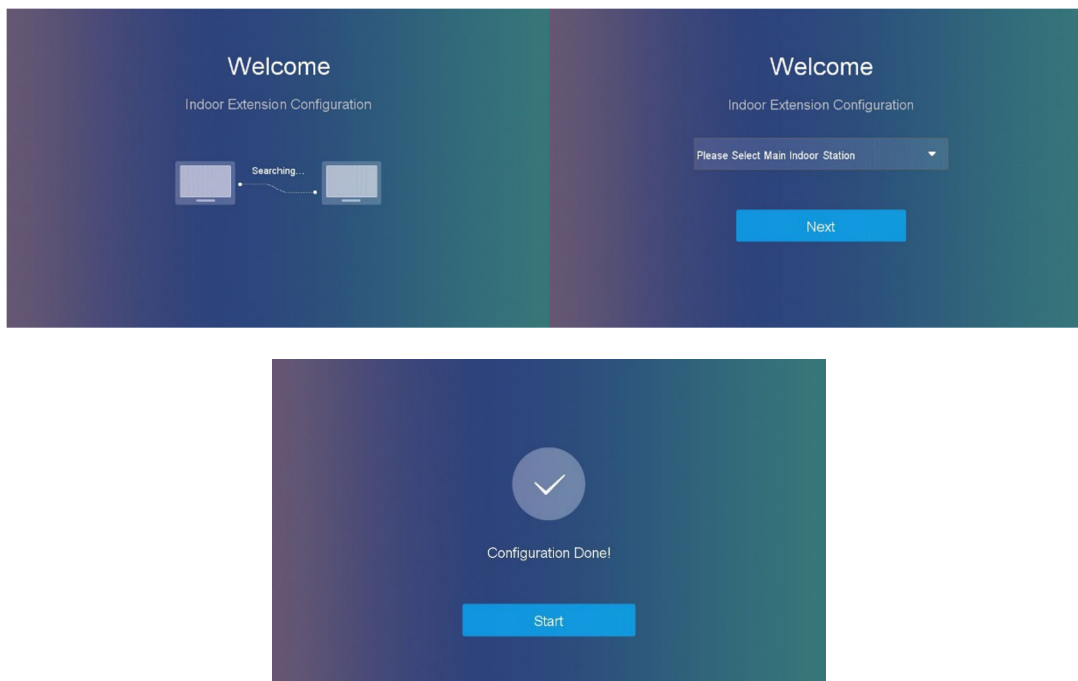

- Indoor and Door Station DHCP function is enabled by default. DHCP can be turned off in Menu.
- Main Indoor Stations support SADP (which allows you to search and find door stations on the same LAN network). In the SADP interface, you can activate and add door stations to indoor stations, synchronize door station with indoor station language, adjust door station volume, and restore door station settings to factory defaults.
- If the door station receives a call, it will automatically take a picture and send it to the indoor station. The picture can be checked in the message interface (the SD card does not support hot plug-and-play and must be inserted and reloaded).
- 30-second voice messages can be left (SD card must be inserted).
- Two-lock control is now supported. You can manually release two locks on the indoor station. One is an electric relay-controlled lock built into the door station, the other is controlled by a secure module and connected to the door station via RS-485 protocol (the secure module is plug-and-play, and only a call accept/decline key can open the lock that is connected to the door station).
- The alarm, call elevator, and call center modules can be deleted on the indoor station.
- The call accept/decline key can be pressed to open the door directly. The unlock key can be pressed to answer/hang up directly.

Title:	RN Two-Wire IP Intercom v1.4.45 v2.0.0 021020NA	Version:	v1.4.45, v2.0.0	Date:	021020
Product:	DS-KH8340-TCE2 and DS-KV8103-IME2	Build:	190410	Page:	4 of 5
Action Required:	None, Information Only				

- **New Functions**

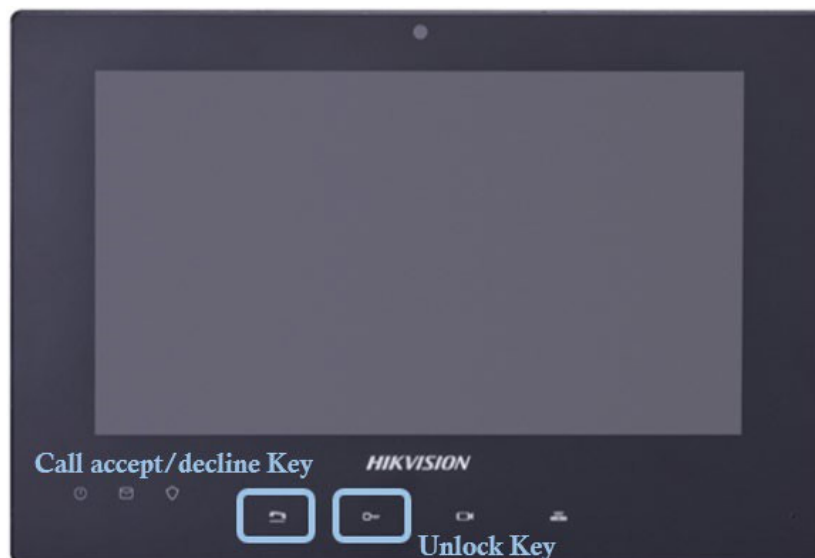

- Factory reset function has been added to the indoor station's local interface.
 - > Caps lock key has been added to the device's touch keyboard.
 - > Live view zoom supported.
 - > NTP function supported (enabled by default). The default time zone is GMT-8 (Los Angeles), and the default NTP server is pool.ntp.org.
 - > The door station now has a button protection mechanism, with 4 s button pressing interval.
 - > HC can connect to DS-KV8103-IME2/US directly.
 - > Voice talk volume and prompted voice volume can separately be adjusted via the indoor station configuration settings.
 - > Pressing the call button on the KV device will send a notification to the indoor station and HC. If the customer selects this option, a message will be sent to the HC after the indoor station is not answered in a specified period of time. The customer can set this value as well.
 - > The door station supports live viewing and voice talk with a person standing in front of it.

Title:	RN Two-Wire IP Intercom v1.4.45 v2.0.0 021020NA	Version:	v1.4.45, v2.0.0	Date:	021020
Product:	DS-KH8340-TCE2 and DS-KV8103-IME2	Build:	190410	Page:	5 of 5
Action Required:	None, Information Only				

■ Customer Impact and Recommended Action

This new firmware upgrade is to improve product performance and will take effect automatically after upgrading from previous versions. This document was created to inform you about the above changes. Also, we are sorry for any possible inconvenience of use-habit changes caused by this action.

For questions or concerns, please contact our local technical support team.

■ NOTES

- Hikvision has all rights to alter, modify, and/or cancel this notice.
- Hikvision doesn't provide any guarantee for old models' stock.
- Hikvision is not liable for any typing or printing errors.
- For special model's change details, please contact our local technical support team.